

## Step 1.

- 1A.** Unpack and connect **Power Supply** to the microPro 300 **Power Connector**.
- 1B.** Plug the microPro 300 into a power outlet.
- 1C.** Launch **microPro Controller App** on the iPad. The App will search for and auto-discover nearby microPro instruments. The name will correspond to the serial number found on the back of the instrument.

**CAUTION:** When removing the instrument, the head will be free to move once removed from the protective foam.

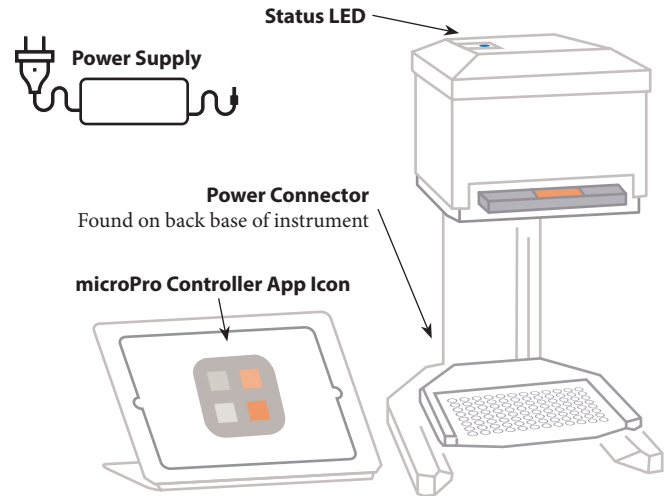

## Step 2.

- 2A.** Verify the bluetooth connection between the microPro 300 and the iPad (The **Status LED** on top of the microPro will turn from red to blue).

**Blue** - Instrument is on, and connected to a tablet

**Red** - Instrument is on, but **NOT** connected to a tablet

**Flashing Red** - Instrument is on, **NOT** connected to a tablet, and has gone into Power Save Mode

- 2B.** When prompted, press the **Run Button** to Home and initialize the instrument. This will take 10-15 seconds.

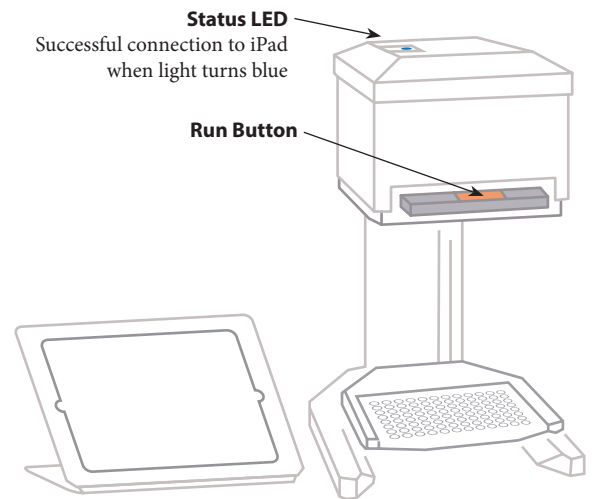

## Step 3.

- 3A.** Press the **Eject Button**  to remove the Shipping Cartridge from the **Instrument Head**.
- 3B.** Place a rack of tips with the cover removed on the **Nest**.
- 3C.** Slide the **Instrument Head** to the top of the tips and, apply 2 pounds of force downward for 2 seconds.
- 3D.** Raise the **Head** up. The tips are now securely installed.

**Congratulations! You are now ready to use your microPro 300 with preconfigured pipette routines, or you can begin to program your own routines by using the Custom Tab.**

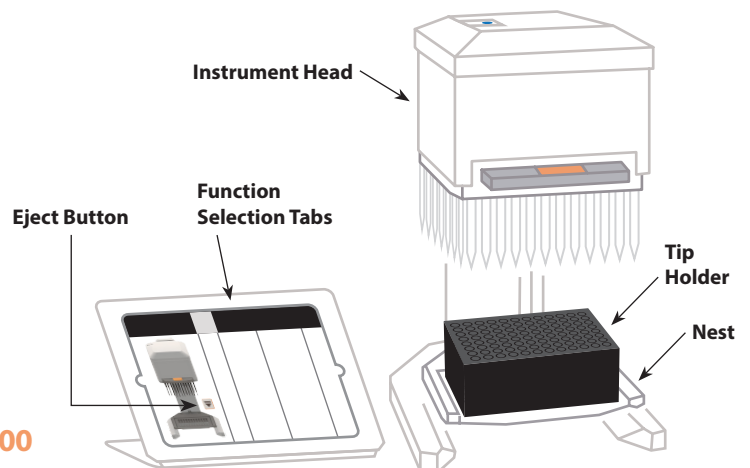

Visit [Avidien.com](http://Avidien.com) for additional information.